

<p style="text-align: center;">Site Location</p> <p>Scale 1:44,180</p>	<p>Land at Oakleaf Farm, Horton Road, Stanwell Moor, Surrey TW19 6AP</p> <p>The construction and use of a recycling, recovery and processing facility for construction and demolition waste on a site of approximately 9.4 hectares comprising: MRF building, site office and workshop; wheel wash and two weighbridges; lorry and car parking area; storage areas; site entrance and access road; and landscaping bunds without compliance with Condition 2 and 4 of planning permission ref. SP/14/01125/SCC dated 13/03/2015 to allow operational flexibility for the access and egress of vehicles based at the site.</p> <p>Application No(s): SP14/01125/SCD1</p> <p>Electoral Division(s): Stanwell & Stanwell Moor</p>
---	---

© Crown copyright. All rights reserved Surrey County Council, 100019613, 2016

This plan is for indicative purposes only

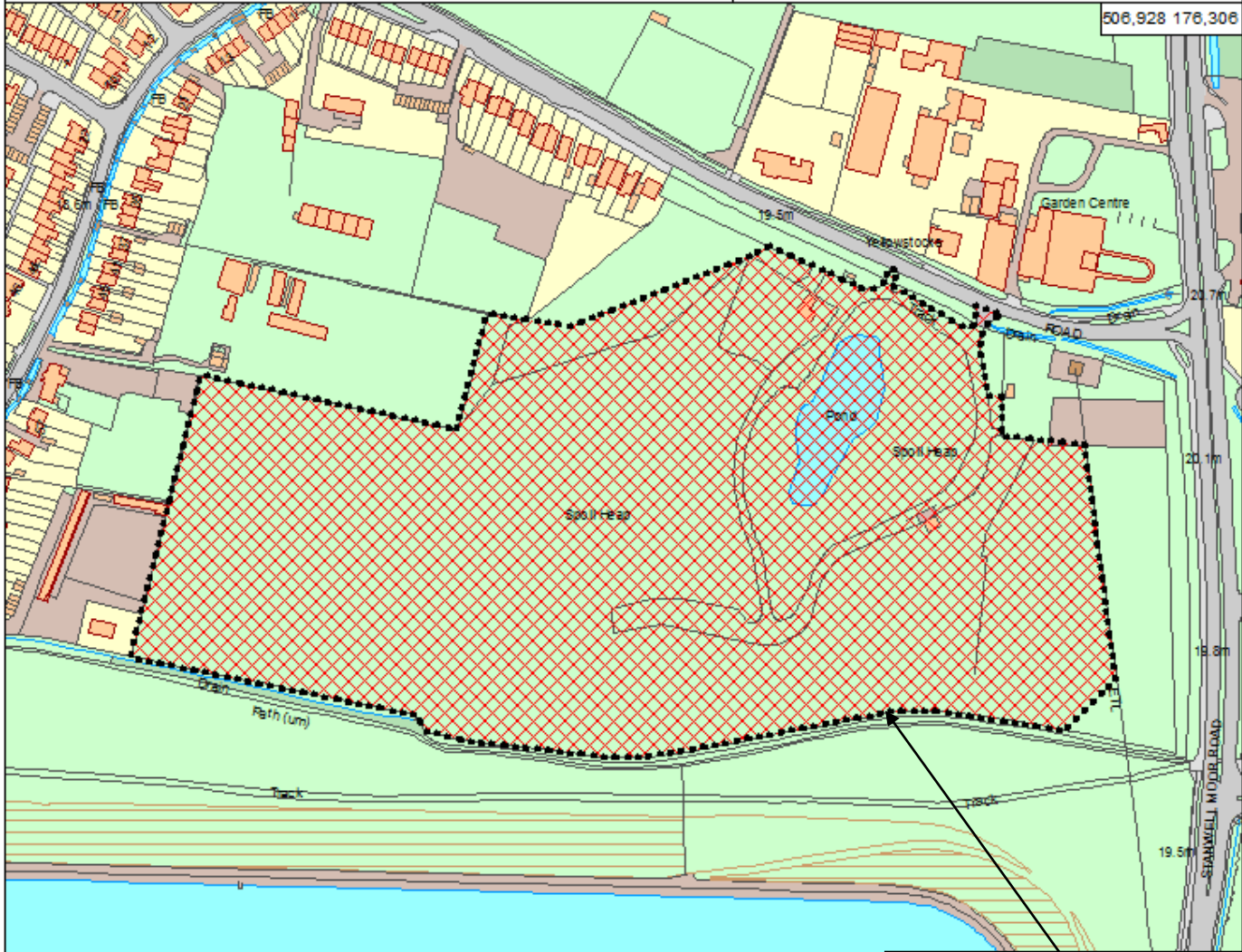

Application Site Area

<p>GRID NORTH</p>	<p>Ref No: SCC REF 2015/0164</p> <p>Date printed: 31/03/2016</p>	<p>0 15 30 60 90 120 150 180 210 Metres</p>	<p>Scale</p> <p>1:3,300</p>
-------------------	--	---	-----------------------------

This page is intentionally left blank